

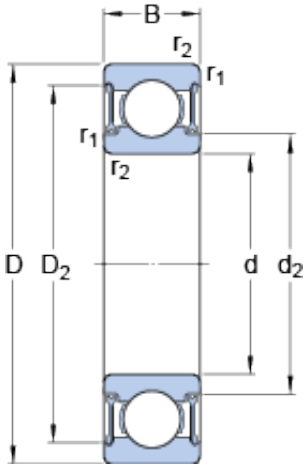

BEARING MANUFACTURING DE MEXICO, S.A.D...



6.35 mm x 19.05 mm x 7.142 mm SKF D/W R4A-2RZ deep groove ball bearings

Bearing No. D/W R4A-2RZ

D/W R4A-2RZ Bearing 2D drawings and 3D CAD models

Size	19.05x6.35x7.142 mm
Bore Diameter	19,05 mm
Outer Diameter	6,35 mm
Width	7,142 mm
d	6.35 mm
D	19.05 mm
B	7.142 mm
d ₂	8.5 mm
D ₂	16.5 mm
r _{1,2} - min.	0.4 mm
d _a - min.	8.4 mm
D _a - max.	16.6 mm
r _a - max.	0.4 mm
Basic dynamic load rating - C	1.5 kN
Basic static load rating - C ₀	0.585 kN
Fatigue load limit - P _u	0.025 kN
Reference speed	80000 r/min
Limiting speed	40000 r/min
Calculation factor - k _r	0.025
Calculation factor - f ₀	7.9
d ₂	8.5 mm
D ₂	16.5 mm
r _{1,2} min.	0.4 mm
d _a min.	8.4 mm



BEARING MANUFACTURING DE MEXICO,S.A.D...

d_a max.	8.4 mm
D_a max.	16.6 mm
r_a max.	0.4 mm
Basic dynamic load rating C	1.53 kN
Basic static load rating C_0	0.585 kN
Fatigue load limit P_u	0.025 kN
Calculation factor k_r	0.025
Calculation factor f_0	7.9
Mass bearing	0.0089 kg