

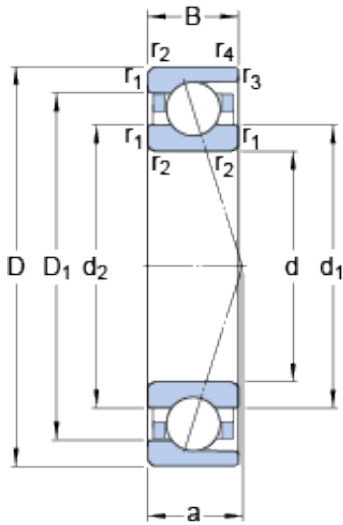

BEARING MANUFACTURING DE MEXICO, S.A.D...



120 mm x 150 mm x 16 mm SKF 71824
ACD/P4 angular contact ball bearings

Bearing No. 71824 ACD/P4

71824 ACD/P4 Bearing 2D drawings and 3D CAD models

Size	150x120x16 mm
Bore Diameter	150 mm
Outer Diameter	120 mm
Width	16 mm
d	120 mm
D	150 mm
B	16 mm
d ₁	129.8 mm
d ₂	129.8 mm
D ₁	140.6 mm
r _{1,2} - min.	1 mm
r _{3,4} - min.	0.3 mm
a	39.5 mm
d _a - min.	124.6 mm
d _b - min.	124.6 mm
D _a - max.	145.4 mm
D _b - max.	148 mm
r _a - max.	1 mm
r _b - max.	0.3 mm
d _n	130.9 mm
Basic dynamic load rating - C	31.2 kN
Basic static load rating - C ₀	42.5 kN
Fatigue load limit - P _u	1.5 kN
Limiting speed for grease	6700 r/min



BEARING MANUFACTURING DE MEXICO, S.A.D...

Lubrication	
Limiting speed for oil lubrication	11000 mm/min
Ball - D_w	8.731 mm
Ball - z	35
G_{ref}	5.5 cm ³
Calculation factor - e	0.68
Calculation factor - Y_2	0.87
Calculation factor - Y_0	0.38
Calculation factor - X_2	0.41
Calculation factor - Y_1	0.92
Calculation factor - Y_2	1.41
Calculation factor - Y_0	0.76
Calculation factor - X_2	0.67
Preload class A - G_A	280 N
Preload class B - G_B	850 N
Preload class C - G_C	1700 N
Calculation factor - f	1.41
Calculation factor - f_1	0.97
Calculation factor - f_{2A}	1
Calculation factor - f_{2B}	1.08
Calculation factor - f_{2C}	1.15
Calculation factor - f_{HC}	1
Preload class A	262 N/micron
Preload class B	417 N/micron
Preload class C	576 N/micron
d_1	129.8 mm
d_2	129.8 mm
D_1	140.6 mm
$r_{1,2}$ min.	1 mm



BEARING MANUFACTURING DE MEXICO, S.A.D...

$r_{3,4}$ min.	0.3 mm
d_a min.	124.6 mm
d_b min.	124.6 mm
D_a max.	145.4 mm
D_b max.	148 mm
r_a max.	1 mm
r_b max.	0.3 mm
d_n	130.9 mm
Basic dynamic load rating C	31.2 kN
Basic static load rating C_0	42.5 kN
Fatigue load limit P_u	1.53 kN
Attainable speed for grease lubrication	6700 r/min
Attainable speed for oil-air lubrication	11000 r/min
Ball diameter D_w	8.731 mm
Number of balls z	35
Reference grease quantity G_{ref}	5.5 cm ³
Preload class A G_A	280 N
Static axial stiffness, preload class A	262 N/ μ m
Preload class B G_B	850 N
Static axial stiffness, preload class B	417 N/ μ m
Preload class C G_C	1700 N
Static axial stiffness, preload class C	576 N/ μ m
Calculation factor f	1.41
Calculation factor f_1	0.97
Calculation factor f_{2A}	1
Calculation factor f_{2B}	1.08
Calculation factor f_{2C}	1.15
Calculation factor f_{HC}	1



BEARING MANUFACTURING DE MEXICO,S.A.D...

Calculation factor e	0.68
Calculation factor (single, tandem) Y_2	0.87
Calculation factor (single, tandem) Y_0	0.38
Calculation factor (single, tandem) X_2	0.41
Calculation factor (back-to-back, face-to-face) Y_1	0.92
Calculation factor (back-to-back, face-to-face) Y_2	1.41
Calculation factor (back-to-back, face-to-face) Y_0	0.76
Calculation factor (back-to-back, face-to-face) X_2	0.67
Mass bearing	0.55 kg