

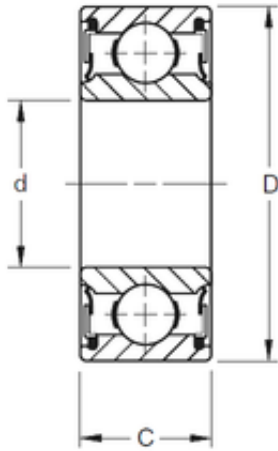

BEARING MANUFACTURING DE MEXICO, S.A.D...



6,35 mm x 19,05 mm x 5,56 mm Timken S1PP
deep groove ball bearings

Bearing No. S1PP

Size	6.35x19.05x5.56 mm
Bore Diameter	6,35 mm
Outer Diameter	19,05 mm
Width	5,56 mm
d	6,35 mm
D	19,05 mm
B	5,56 mm
C	5,56 mm
Weight	0,009 Kg
Basic dynamic load rating (C)	3,1 kN

S1PP Bearing 2D drawings and 3D CAD models